



#### **JPE160 Exhibition:**

JPE is celebrating its 160th year of practice this year. In a retrospective exhibition we look back at the decades, directors and designs which have shaped key aspects of South Australia's history and what JPE Design Studio is today. The exhibition, a visual essay spanning our entire office space, opens to the public on 21st October 2011 and will run for one month. Please feel free to pop by during office hours and take a historical architectural journey!

#### **SA Architecture Awards:**

Earlier this year saw JPE receive two highly acclaimed awards at the SA Architecture Awards. The JPE Design Studio received an Architectural Award, 'Dressed in black. Smooth and smoky.' described the jury. Meanwhile, The Wave and Edge received a commendation for the Adelaide Prize, a proud moment for all those involved in the project. JPE Director, Adrian Evans, describes the importance of the buildings within the public realm, 'These two buildings assist in the public recognition of the Southern Precinct and together with the Optus Building provide a dignified gateway entry to the CBD along King William Street.'

#### **Hills Head Office Fitout:**

JPE in collaboration with the Hills management and staff have designed an exciting new Head Office environment for the iconic South Australian company. The design sought to represent key values and traditions of the company such as: iconic beginnings, safety, environmental responsibility, technology and electronics, innovation, loyal people, industrial environment with soft touches and a continually evolving range of products. We congratulate Hills Industries on their move to the new headquarters and wish the company well for the future.

#### **CML Hotel Conversion:**

JPE have been appointed as architects and interior designers for the \$35m conversion of the historic CML building at 45 King William Street. Originally built in the late 1920's and early 1930's as offices for Colonial Mutual Life, this wonderful Adelaide landmark is ideally located to become one of our great hotels. We are working with Adabco, the owners and operators of the hotel. The basement, ground and first floors will house public facilities such as bar, restaurant, reception, high class retail, function rooms and meeting rooms as well as back of house services. An executive lounge is planned for the top of the building with an associated outdoor terrace enjoying stunning views across the city. Our design inspiration comes from the style and grace of the existing building as well as references back to the era of the 1930's. A grand curved staircase of polished stainless steel with rich red carpet connects the three public floors. Onyx stone in large slabs will be used to create the reception desk, the concierge desk and bars as another rich unifying element within the hotel. Adabco were also our client for the Wave and Edge projects and we thank them for their continued loyalty to JPE and commend them for their ongoing commitment to the City of Adelaide.

#### **Marryatville High School:**

JPE are currently working with Marryatville High School to design an exemplary new science facility for the school, along with significant upgrades to improve the quality, flexibility and accessibility of the indoor and outdoor learning and social environments throughout the rest of the campus. By using latest research in education models, this project also represents an exciting opportunity to explore the relationship between design and learning, to deliver inspiring learning environments linked with the beautiful natural setting of First Creek and a new student plaza.

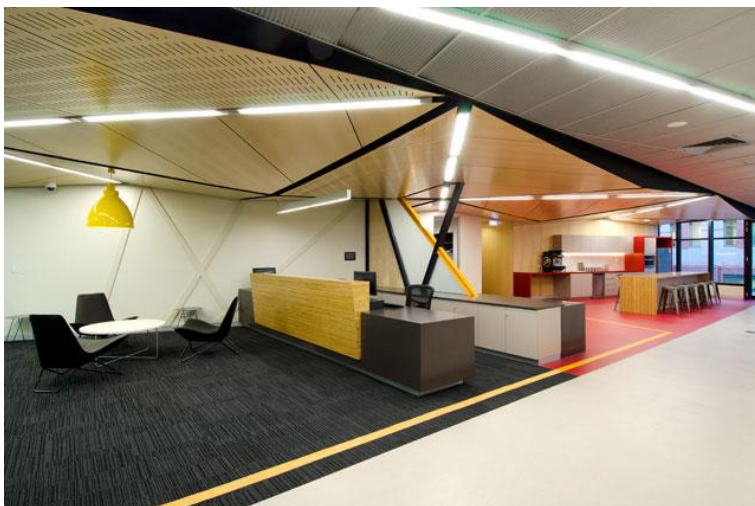



### **Surflen Street Apartments:**

On a land-locked site in the south-east of the CBD, JPE have reinterpreted the local industrial aesthetic to create a distinctive multi-residential development comprising of 49 apartments over 7 levels. The development aims to promote bicycle travel as a viable alternative to the car, and offers a prominent shop-front style bike parking and storage facility facing the street – further promoting this form of transport. This bike store will incorporate a bike workshop, giving residents a dedicated place to change tyres, tune and adjust their bikes. A number of internal light-voids provide natural light, ventilation and view to the apartment and public areas, and make use of vertical gardens to connect levels and spaces. By embracing and reinterpreting the unique qualities of the local context, JPE have created a design solution that is contemporary and relevant, while also speaking the language of its contextual past.

### **Dysart Urban Design Framework:**

Following the success of the Clermont Urban Design Framework in Queensland's mid-north, JPE have recently been engaged by the Isaac Regional Council to develop an urban design framework for the town of Dysart. Teaming up with WAX Design, JPE will be working closely with Council and the Dysart community from now until early 2012 to explore ways in which the urban and landscape character of Dysart can improve the lifestyle and environment for the town's current and future residents.

### **Design Techniques for Noise & Air Quality:**

JPE were recently engaged by the Department of Planning and Local Government to test and provide design advice on the new Minister's Specification relating to noise and air emissions. JPE identified nominal infill sites, and developed mixed use residential design responses that incorporated principles and techniques to assist in the control of noise and air quality from adjacent road and rail noise sources. Rather than relying on secondary building elements, JPE explored ways to deal with noise and air quality in the primary design elements including building form and massing, apartment layout and room orientation, and integrated façade treatments. In addition JPE's Case Studies incorporated the objectives and desired development character as set out in the new planning policy modules currently being drafted.

### **Art of Nature:**

Complementing his role as a registered landscape architect in the JPE Team, David Gregory has recently claimed top prize in the Belair National Park category of the 'Art Of Nature' tee-shirt design competition, being run by the Government of SA (Department of Natural Resources). David's design 'Grey Box Woodland', celebrates the remnant native landscape of the Adelaide hills, and our role in protecting this unique environment for future generations. If you like the design, head to Womad Earth Station Festival in October and pick up a teeshirt!

